



### HOOK CONNECTORS

The 5 connector styles shown below make it possible for Crosby to furnish a Golden Gate Hook to fit almost any make or model of hoisting equipment including, American Engineering Lo-Hed, ARO, Coffing, Electro Lift, Ingersoll-Rand, P & H, Robbins and Myers, Shepard Niles, CM, Shaw-Box, Wright, Yale & Towne.

#### CLOSED SWIVEL BAIL

For use where hoisting line or shackle can be inserted into the bail. Suitable for positioning before lifting. Hook sizes: 1 through 14.

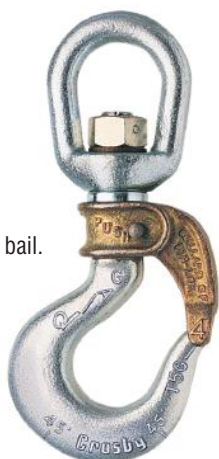

**Style C** — with self-closing gate.  
**Style A** — with manual-closing gate.

#### SHANK-TYPE HOOK

(Standard Length)

For use on existing load blocks, with standard shank length. Hook sizes: 2 through 14.



**Style D** — with self-closing gate.  
**Style B** — with manual-closing gate.

#### SHANK-TYPE HOOK

(Long Length)

For use on existing load blocks requiring extra shank length. Hook sizes: 4 through 17.

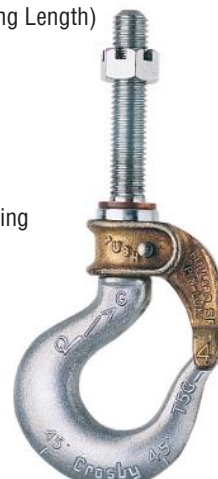

**Style K** — with self-closing gate.  
**Style I** — with manual-closing gate.

#### UNIVERSAL TYPE

Open swivel bail for attachment to link chain. Suitable for positioning before lifting. Hook sizes: 3, 4, and 5.

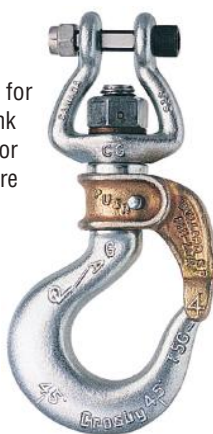

**Style E** — with self-closing gate.  
**Style G** — with manual-closing gate.

#### LINK CHAIN NEST

With ball-bearing swivel; attaches to chain by an alloy pin. Suitable for frequent rotation under load. Hook sizes: 4, 5, and 7.

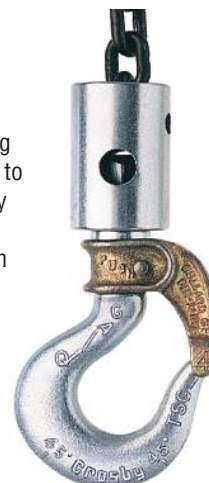

**Style O** — with self-closing gate.  
**Style P** — with manual-closing gate.

Letter designations shown beneath each illustration above indicate BOTH connector style and gate type. Each connector is available with either a self-closing or manual-closing gate. (e.g. A size 4 hook with a closed swivel bail connector and self-closing gate is 4-C; with manual-closing gate, it is 4-A.)



HOOKS & SWIVELS

GATE TYPES

Brass alloy Golden Gates® are engineered for quality, easy handling and dependability. The heavy duty, corrosion resistant locking mechanism will stay locked until an operator releases it; yet, can easily be shut with one hand. Cost effective, these gates reduce down time, providing the alternative to conventional latches.

4

LIF-LOK® GATE - SIZE 1

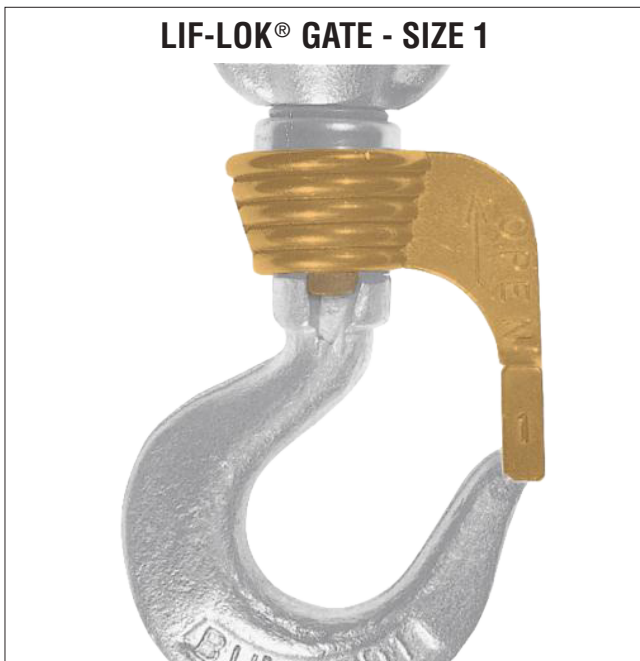

**To lock:** Close the gate; the built-in spring locks the gate against the hook tip.  
**To Unlock:** Lift the gate upward on the hook shank and swing open.

ROLLOX® GATE - SIZE 5 through 9



**To Lock:** Close the gate; a stainless steel pin is mounted in a horizontal bore which passes through the gate and engages a notch milled in the hook shank.  
**To Unlock:** Move the lever downward a quarter-turn or until it stops, the gate can now swing open 160° (approx.)

PIN-LOK® GATE - SIZE 2 through 4

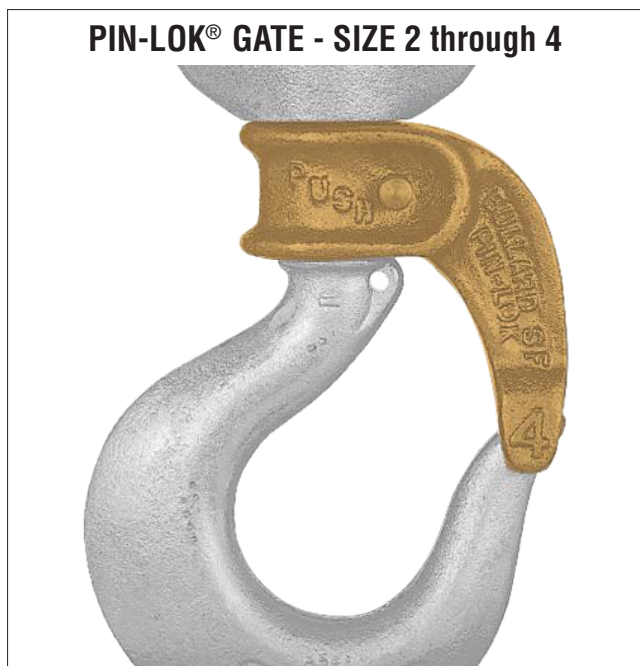

**To Lock:** Close the gate; a stainless steel pin is carried in a horizontal bore and engages a milled slot in the hook shank.  
**To Unlock:** Simply depress the stainless steel pin which causes the pin to disengage from the milled slot.

TIP-LOK® GATE - SIZE 10 through 17

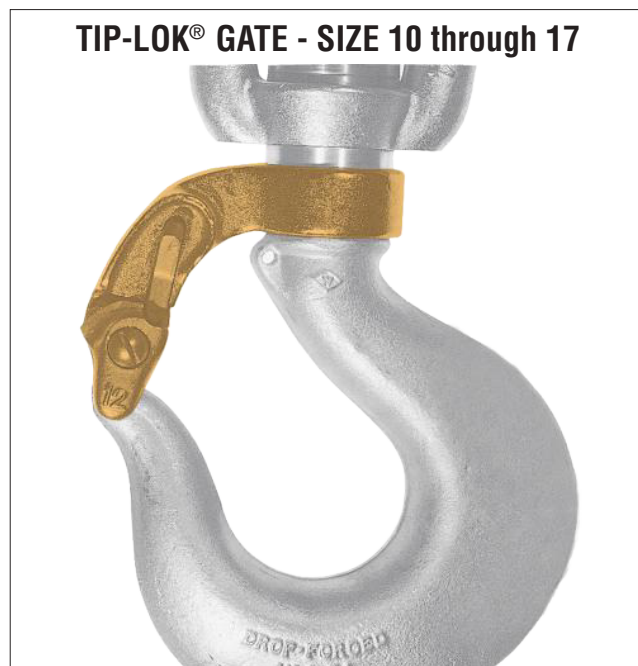

**To Lock:** Press the arm down until the lock trips; two arms of the gate now enclose the tip of the hook.  
**To Unlock:** Manually depressing the locking trigger automatically raises the movable arm, allowing the gate to be rotated open.



L-322CN / L-322AN



- Forged, Quenched & Tempered.
- Suitable for positioning of the hook before the load is lifted.
- Swivel hooks are load rated.
- Proper design, careful forging, and precision controlled quench and tempering gives maximum strength without excessive weight and bulk.
- Low profile hook tip designed to utilize Crosby S-4320 or PL-N latch kit.
- Hooks incorporate QUIC-CHECK® deformation and angle indicators. (For detailed information, see the Crosby Value Added page at the beginning of this section.)

Use in corrosive environment requires shank and nut inspection in accordance with ASME B30.10-1.10.4(b)(5)(c).

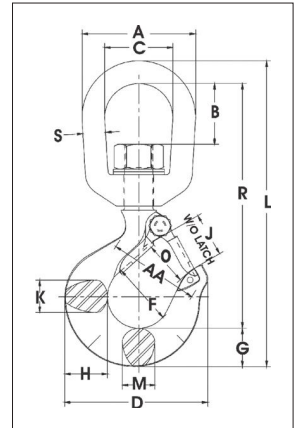

APPLICATION AND WARNING INFORMATION SECTION 17

L-322CN / L-322AN Swivel Hooks with Latch

Working Load Limit (t)		Hook ID Code*	L-322CN Stock No.	L-322AN Stock No.	Weight Each (kg)	Dimensions (mm)														Rep. Latch Stock No.	
Carbon	Alloy					A	B	C	D	F	G	H	J	K	L	M	O †	R	S		AA*
0.75	1	D	1048603	1048807	.34	51.0	20.8	31.8	72.5	31.8	18.5	20.6	23.6	16.0	144	16.0	23.6	116	9.65	38.1	1096325
1	1.5	F	1048612	1048816	.57	63.5	33.3	38.1	80.0	35.1	21.3	23.9	24.6	18.0	170	18.0	24.6	136	12.7	50.8	1096374
1.5	2	G	1048621	1048825	1.02	76.0	38.1	44.5	91.0	38.1	25.4	29.5	26.9	22.4	197	22.4	26.9	155	16.0	50.8	1096421
2	3	H	1048630	1048834	1.04	76.0	38.1	44.5	102	41.1	28.7	33.3	30.2	23.9	210	23.9	29.5	165	16.0	50.8	1096468
3	5	I	1048639	1048840	2.25	89.0	41.7	50.8	123	51.0	36.6	41.4	38.1	33.3	246	28.7	35.8	191	19.1	63.5	1096515
5	7	J	1048648	1048859	4.67	116	58.0	63.5	160	63.5	46.0	52.5	45.2	42.2	317	36.6	42.9	245	25.4	76.2	1096562
7.5	11	K	1048657	1048868	8.80	127	62.0	70.0	192	76.0	57.0	67.0	51.0	47.8	375	41.4	56.5	289	28.7	101	1096609
10	15	L	1048666	1048880	10.5	143	63.0	79.0	212	82.5	66.0	74.5	66.5	55.5	417	49.3	61.0	311	31.8	101	1096657
15	22	N	1048675	1048889	21.3	180	95.5	104	263	108	76.0	89.0	86.5	68.5	542	60.5	81.0	424	38.1	127	1096704
-	30	O	-	1048898	32.0	180	95.5	104	346	127	93.0	118	102	72.5	590	76.2	82.6	459	38.1	165	1090161

All carbon swivel hooks have a 5:1 Design Factor and Proof Load is 2 times the Working Load Limit. Alloy swivel hooks 1t through 22t have a 4.5:1 Design Factor and Proof Load is 2.5 times the Working Load Limit. Alloy swivel hooks of 30t capacity have a 4:1 Design Factor and Proof Load is 2 times the Working Load Limit. \*Deformation indicators †Dimensions for hooks 3/4t carbon through 22t alloy are for S-4320 latch kits. Dimensions for hooks 30t alloy are for 4055 latch kit.



HOOKS & SWIVELS

L-3322B



- Bearing design allows hook to rotate freely under load.
- Capacities ranging from 2 through 15 metric tons.
- Forged, Quenched & Tempered.
- Low profile hook tip designed to utilize Crosby S-4320 or PL-N latch kit.
- L-3322 hooks incorporate QUIC-CHECK® deformation and angle indicators. (For detailed information, see the Crosby Value Added page at the beginning of this section.)

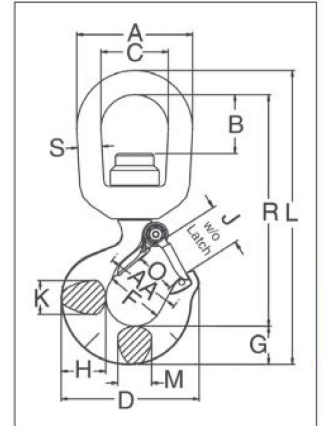

4



APPLICATION AND WARNING INFORMATION SECTION 17

L-3322B Swivel Hooks with Bearing

Working Load Limit (t)	Hook ID Code*	Stock No.	Weight Each (kg)	Dimensions (mm)																Rep. Latch Stock No.
				A	B	C	D	F	G	H	J	K	L	M	O	R	S	AA*		
2	GA	1028609	1.13	76.2	38.1	44.5	91.2	38.1	25.4	29.5	26.9	22.4	194	22.4	25.4	152	16.0	50.8	1096421	
3	HA	1028618	1.72	88.9	39.6	50.8	101	41.1	28.7	33.3	30.2	23.9	218	23.9	27.7	170	19.1	50.8	1096468	
5	IA	1028627	3.17	101	39.6	57.2	122	50.8	36.6	41.4	38.1	33.3	262	28.7	34.5	203	22.4	63.5	1096515	
7	JA	1028636	6.35	127	49.3	69.9	159	63.5	46.0	52.3	45.2	42.2	326	36.6	40.9	251	28.7	76.2	1096562	
11	KA	1028645	10.1	142	52.1	79.2	191	76.2	57.2	66.8	61.2	47.8	387	41.4	52.8	298	31.8	101	1096609	
15	LA	1028654	16.3	180	91.9	104	211	82.6	65.8	74.7	66.5	55.6	473	49.3	57.7	366	38.1	101	1096657	

4.5:1 Design Factor. Maximum allowable proof load is 2.5 times Working Load Limit. \*Deformation indicators.



HOOKS & SWIVELS

S-1326



- The S-1326 hook is a positioning device and is not intended to rotate under load. For swivel hook designed to rotate under load, use the S-13326.
- S-13326 Swivel Hook utilizes anti-friction bearing design which allows hook to rotate freely under load.
- Rated for both wire rope and for use with Grade 80/100 chain.
- Forged alloy steel, Quenched & Tempered.
- Individually Proof Tested at 2-1/2 times the chain Working Load Limit with certification.
- Recessed trigger design is flush with the hook body, protecting the trigger from potential damage.
- Easy to operate with enlarged thumb access.
- Positive lock latch is self-locking when hook is loaded.
- Trigger repair kit available (S-4316). Consists of spring, roll pin, and trigger.
- Fatigue rated to 20,000 cycles at 1-1/2 times the Working Load Limit.
- The SHUR-LOC® Hook, if properly installed and locked, can be used for personnel lifting applications and meets the intent of OSHA Rule 1926.1431(g)(1)(i)(A) and 1926.1501(g)(4)(iv)(B).

S-13326



4

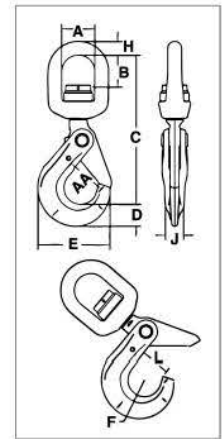
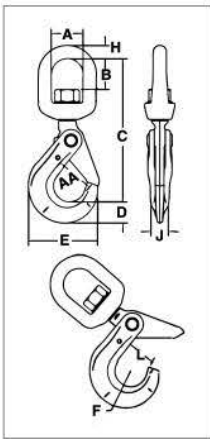

S-1326 SHUR-LOC® Swivel Hooks Suitable for positioning before lifting.

Chain Size		Frame code	Grade 10 Alloy Chain Working Load Limit (t)		Stock No.	Weight Each (kg)	Dimensions (mm)									
(in)	(mm)		4:1 Design Factor	5:1 Design Factor			A	B	C	D	E	F	H	J	L	AA*
-	6	D	1.45	1.16	1004304	.57	38.1	33.5	156	20.1	66.0	17.0	12.7	16.0	28.7	38.1
1/4 - 5/16	7-8	G	2.60	2.1	1004313	1.18	44.5	40.4	193	27.9	88.9	22.1	16.0	20.6	35.1	51.0
3/8	10	H	4.00	3.2	1004322	2.13	50.8	43.9	224	29.7	112	27.9	19.1	23.9	44.5	63.5
1/2	13	I	6.80	5.4	1004331	3.92	63.5	60.5	284	42.4	139	32.0	25.4	29.5	53.6	76.2
5/8	16	-	10.3	8.2	1004340	7.71	69.9	64.3	328	51.8	167	38.1	28.7	38.1	63.2	89.0
3/4	18 - 20	-	16.0	12.8	1004349	10.9	71.9	64.0	358	56.4	197	51.1	27.9	51.6	89.4	127
7/8	22	-	20.0	16.0	1004358	13.2	87.4	81.0	417	62.2	222	57.4	33.0	55.9	97.3	152

\*Deformation indicators.

S-13326 SHUR-LOC® Swivel Hooks with Bearing Suitable for frequent rotation under load.

Chain Size		Frame code	Grade 10 Alloy Chain Working Load Limit (t)		Stock No.	Weight Each (kg)	Dimensions (mm)									
(in)	(mm)		4:1 Design Factor	5:1 Design Factor			A	B	C	D	E	F	H	J	L	AA*
-	6	D	1.45	1.16	1004404	.57	38.1	29.0	157	20.1	66.0	17.0	12.7	16.0	28.7	38.1
1/4 - 5/16	7-8	G	2.60	2.1	1004413	1.18	44.5	38.6	192	27.9	89.0	22.1	16.0	20.6	35.1	51.0
3/8	10	H	4.00	3.2	1004422	2.13	51.0	40.9	226	29.7	112	27.9	19.1	23.9	46.5	63.5
1/2	13	I	6.80	5.4	1004431	3.92	63.5	51.6	282	42.4	138	32.0	25.4	29.5	53.5	76.2
5/8	16	-	10.3	8.2	1004440	7.71	70.0	50.3	328	52.0	167	38.1	28.7	38.1	63.0	89.0

\*Deformation indicators.



S-13326H



S-1316AH



- The SHUR-LOC® Handle Hook allows the user to get a confident grip on a load with ease and comfort.
- Designed with a handle opening big enough to comfortably fit a gloved hand.
- Positive lock latch is self-locking when hook is loaded.
- Rated for both wire rope and use with Grade 80/100 chain.
- S-13326H Swivel Hook utilizes anti-friction bearing design which allows hook to rotate freely under load.
- Individually Proof Tested at 2-1/2 times the chain Working Load Limit with certification.
- The replaceable pull-trigger allows the user to easily open the SHUR-LOC's positive self-locking latch.
  - Ergonomically designed for easy use and precise control.
  - Secondary side trigger is recessed to avoid inadvertent release.
- Fatigue rated to 20,000 cycles at 1-1/2 times the Working Load Limit.
- Forged alloy steel, Quenched & Tempered.
- The SHUR-LOC® hook, if properly installed and locked, can be used for personnel lifting applications and meets the intent of OSHA Rule 1926.1431(g)(1)(i)(A) and 1926.1501(g)(4)(iv)(B).

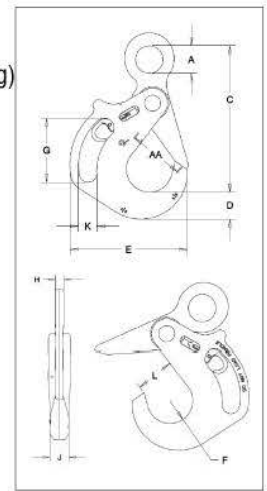
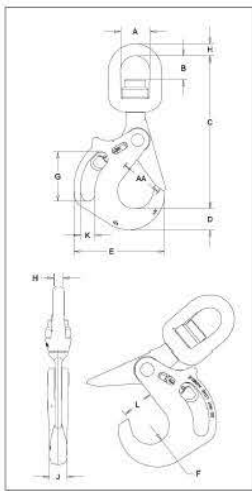

APPLICATION AND WARNING INFORMATION SECTION 17

**S-13326H SHUR-LOC® Handle Swivel Hooks with Bearings**

Chain Size		Grade 10 Alloy Chain Working Load Limit (t) 4:1*	Working Load Limit (t) 5:1*	Frame Code	Stock No.	Weight Each (kg)	Dimensions (mm)											
(in)	(mm)						A	B	C	D	E	F	G	H	J	K	L	AA*
5/8	16	10.3	8.2	JA	1005014	11.8	69.9	57.2	272	50	217	42.5	119	28.7	44	33.5	71	102
3/4	18/20	16.0	12.8	KA	1005023	16.8	79.2	51.9	393	66	255	50.5	120	31.8	52	32	84	127
7/8	22	19.4	15.5	LA	1005041	25.9	104	92.7	482	69	292	57	136	41.4	62	40	93	152
1	26	27.1	21.7	NA	1005050	38.1	127	102	547	79	324	64	164	41.4	70	40	104	165

4:1 Design Factor. \*Deformation indicators.

**S-1316AH SHUR-LOC® Handle Eye Hook**

Chain Size		Grade 10 Alloy Chain Working Load Limit (t) 4:1*	Working Load Limit (t) 5:1*	Frame Code	Stock No.	Weight Each (kg)	Dimensions (mm)											
(in)	(mm)						A	B	C	D	E	F	G	H	J	K	L	AA*
5/8	16	10.3	8.2	JA	1023579	8.2	51	10.69	272	50	217	42.5	119	20	44	33.5	71	102
3/4	18/20	16.0	12.8	KA	1023599	12.7	70	12.03	306	66	255	50.5	120	22	52	32	84	127
7/8	22	19.4	15.5	LA	1023607	17.7	80	13.46	342	69	292	57	136	91	62	40	93	152
1	26	27.1	21.7	NA	1023625	27.2	90	15.55	395	79	324	64	164	30	70	40	104	165

4:1 Design Factor. \*Deformation indicators.



Closed Swivel Bail



- For use where hoisting line or shackle can be inserted into the bail.
  - BL-C with self-closing gate
  - BL-A with manual-closing gate
- Suitable for positioning before lifting.
- Crosby Bullard® Hooks incorporate QUIC-CHECK® deformation and angle indicators. (For detailed information, see the Crosby Value Added page at the beginning of this section.)

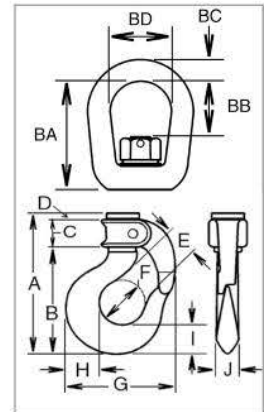

APPLICATION AND WARNING INFORMATION SECTION 17

Closed Swivel Bail

Hook Size	BL-C Stock No.	BL-A Stock No.	Gate Type	Working Load Limit (t)	Weight Each (kg)	Dimensions (mm)													
						A	B	C	D	E	F	G	H	I	J	BA	BB	BC	BD
1	1050210	1050001	LIF-LOK	.45	.36	82.0	58.7	16.0	6.60	17.5	22.4	57.0	17.5	16.0	11.2	44.5	16.0	7.85	25.4
2	1050221	1050012	PIN-LOK	.90	.59	105	76.2	23.6	4.06	24.6	31.8	73.0	20.6	19.1	11.2	47.2	24.1	9.65	31.8
3	1050232	1050023	PIN-LOK	1.3	.86	114	84.0	23.9	5.58	26.9	35.1	84.0	23.9	21.3	16.0	62.0	33.3	12.7	38.1
4	1050243	1050034	PIN-LOK	1.5	1.00	124	92.2	25.4	5.58	28.7	38.1	92.0	29.5	25.4	19.1	67.5	34.3	12.7	38.1
5	1050254	1050045	ROLLOX	2.1	1.72	143	105	31.2	6.35	31.8	41.7	104	33.3	28.4	21.3	74.0	40.6	16.0	44.5
6	1050265	1050056	ROLLOX	3.6	2.09	158	119	31.8	6.35	35.3	41.7	116	39.9	34.0	24.6	78.5	35.8	16.0	44.5
7	1050276	1050067	ROLLOX	3.8	3.13	168	132	28.4	6.35	38.1	51.0	125	41.4	36.6	28.7	88.5	42.4	19.1	51.0
8	1050287	1050078	ROLLOX	5.0	4.35	182	147	26.9	7.11	44.5	57.0	148	51.0	41.9	31.2	103	51.0	22.4	57.0
9	1050298	1050089	ROLLOX	6.5	6.12	199	164	26.9	7.87	47.8	63.5	165	52.5	46.0	35.1	118	56.0	26.2	63.5
11	1050309	1050100	TIP-LOK	8.3	9.30	244	203	31.8	7.87	57.0	76.0	192	67.0	57.0	41.1	124	66.5	28.7	70.0
12	1050320	1050111	TIP-LOK	11.1	12.3	267	225	31.8	9.65	63.5	82.5	221	74.5	65.5	49.3	130	57.0	31.8	79.5
14	1050342	1050133	TIP-LOK	16.7	25.0	320	273	35.8	9.65	86.0	108	279	89.0	75.5	60.5	203	108	41.4	104

4:1 Design Factor.

Open Swivel Bail



- Open Swivel Bail for attachment to link chain.
  - BL-E with self-closing gate
  - BL-G with manual-closing gate
- Suitable for positioning before lifting.
- Crosby Bullard® Hooks incorporate QUIC-CHECK® deformation and angle indicators. (For detailed information, see the Crosby Value Added page at the beginning of this section.)

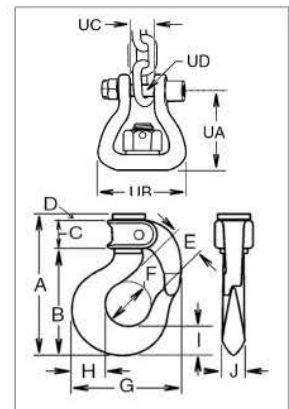

Open Swivel Bail

Hook Size	BL-E Stock No.	BL-G Stock No.	Gate Type	Working Load Limit (t)	Weight Each (kg)	Dimensions (mm)													
						A	B	C	D	E	F	G	H	I	J	UA	UB	UC	UD
3	1051607	1051706	PIN-LOK	1.3	.81	114	84.5	23.9	5.58	26.9	35.1	81.0	23.9	21.3	16.0	53.0	59.0	13.2	9.65
4	1051618	1051717	PIN-LOK	1.5	.95	124	92.2	25.4	5.58	28.7	38.1	92.0	29.5	25.4	19.1	54.5	59.0	13.2	9.65
5	1051629	1051728	ROLLOX	2.1	1.45	143	105	31.2	6.35	31.8	41.7	104	33.3	28.4	21.3	65.0	67.0	15.7	11.2

4:1 Design Factor.

HOOKS & SWIVELS



HOOKS & SWIVELS

Link Chain Nest



- With ball bearing swivel; attaches to chain by an alloy pin.
  - BL-O with self-closing gate
  - BL-P with manual-closing gate
- Suitable for frequent rotation under load.
- Crosby Bullard® Hooks incorporate QUIC-CHECK® deformation and angle indicators. (For detailed information, see the Crosby Value Added page at the beginning of this section.)

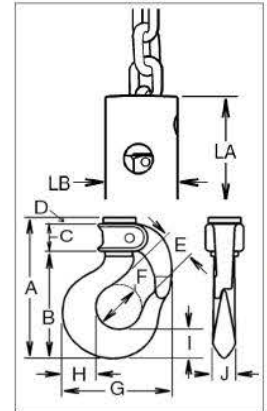

4



APPLICATION AND WARNING INFORMATION SECTION 17

Link Chain Nest

Chain Size	BL-O Stock No.	BL-P Stock No.	Gate Type	Working Load Limit (t)	Weight Each (kg)	Dimensions (mm)												
						A	B	C	D	E	F	G	H	I	J	LA	LB	
4:1/4-9/32	1051409	1051508	PIN-LOK	1.5	1.13	124	92.2	25.4	5.58	28.7	38.1	92.0	29.5	25.4	19.1	67.0	44.5	
5:5/16-3/8	1051442	1051541	ROLLOX	2.1	2.04	143	105	31.2	6.35	31.8	41.7	104	33.3	28.4	21.3	76.0	57.0	
7:3/8-7/16	1051464	1051563	ROLLOX	3.8	5.0	168	132	28.4	6.35	38.1	51.0	125	41.4	36.6	28.7	111	76.0	
7:1/2-9/16	1051486	1051585	ROLLOX	3.8	5.0	168	132	28.4	6.35	38.1	51.0	125	41.4	36.6	28.7	111	76.0	

4:1 Design Factor.

Standard Length



- For use on existing load blocks, with standard shank length.
  - BL-D with self-closing gate
  - BL-B with manual-closing gate
- Numbers 2 through 12 style hooks are threaded approximately 80% of shank length.
- Crosby Bullard® Hooks incorporate QUIC-CHECK® deformation and angle indicators. (For detailed information, see the Crosby Value Added page at the beginning of this section.)

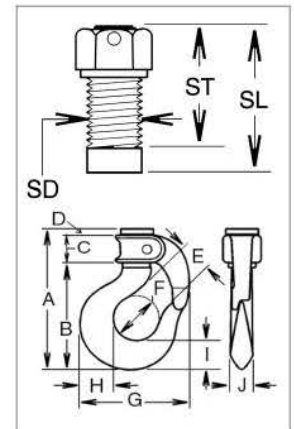

APPLICATION AND WARNING INFORMATION SECTION 17

Standard Length Shank Hooks

Hook Size	BL-D Stock No.	BL-B Stock No.	Gate Type	Working Load Limit (t)	Weight Each (kg)	Dimensions (mm)												
						A	B	C	D	E	F	G	H	I	J	SD	SL	ST
2	1050606	1050408	PIN-LOK	.91	.50	105	76.2	23.6	4.06	24.6	31.8	73.0	20.6	19.1	14.2	12.7	23.1	15
3	1050617	1050419	PIN-LOK	1.3	.59	114	84.1	23.9	5.58	26.9	35.1	81.0	23.9	21.3	16.0	14.2	31.8	19.1
4	1050628	1050430	PIN-LOK	1.5	.77	124	92.2	25.4	5.58	28.7	38.1	92.0	29.5	25.4	19.1	16	33.3	30.2
5	1050639	1050441	ROLLOX	2.1	1.13	143	105	31.2	6.35	31.8	41.7	104	33.3	28.4	21.3	19.1	33.3	25.4
6	1050650	1050452	ROLLOX	3.6	1.59	158	119	31.8	6.35	35.3	41.7	116	39.9	34.0	24.6	22.4	43	29.5
7	1050661	1050463	ROLLOX	3.8	2.36	168	132	28.4	6.35	38.1	51.0	125	41.4	36.6	28.7	25.4	46	35.1
8	1050672	1050474	ROLLOX	5.0	3.22	182	147	26.9	7.11	44.5	57.0	148	51.0	41.9	31.2	28.7	52.5	38.1
9	1050683	1050485	ROLLOX	6.5	4.31	199	164	26.9	7.87	47.8	63.5	165	52.5	46.0	35.1	31.8	62	46
11	1050694	1050496	TIP-LOK	8.3	7.08	244	203	31.8	7.87	57.0	76.0	192	67.0	57.0	41.1	38.1	68.5	47.8
12	1050705	1050507	TIP-LOK	11.2	9.53	267	225	31.8	9.65	63.5	82.5	221	74.5	65.5	49.3	41.4	73	54
13	1050716	1050518	TIP-LOK	13.6	13.6	285	242	31.8	9.65	76.0	95.0	245	83.5	70.0	49.3	44.5	89	56
14	1050727	1050529	TIP-LOK	16.8	18.1	320	273	35.8	9.65	86.0	108	279	89.0	75.5	60.5	51	92.5	60.5

4:1 Design Factor.







Long Length



- For use on existing load blocks requiring extra shank length.
  - BL-K with self-closing gate
  - BL-I with manual closing gate
- Numbers 4 through 9 style hooks are threaded approximately 80% of shank length.
- Crosby Bullard® Hooks incorporate QUIC-CHECK® deformation and angle indicators.

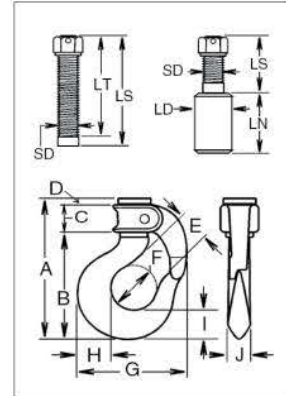

APPLICATION AND WARNING INFORMATION SECTION 17

Long Length Shank Hooks

Hook Size	BL-K Stock No.	BL-I Stock No.	Gate Type	Working Load Limit (t)	Weight Each (kg)	Dimensions (mm)														
						A	B	C	D	E	F	G	H	I	J	SD	LN	LS	LT	
4 :1/2	1051002	1050804	PIN-LOK	1.45	.86	124	92.2	25.4	5.58	28.7	38.1	92.0	29.5	25.4	19.1	12.7	11.2	81.0	81.0	
4 :9/16	1051013	1050815	PIN-LOK	1.5	.86	124	92.2	25.4	5.58	28.7	38.1	92.0	29.5	25.4	19.1	14.2	12.2	81.0	81.0	
4 :5/8	1051024	1050826	PIN-LOK	1.5	.86	124	92.2	25.4	5.58	28.7	38.1	92.0	29.5	25.4	19.1	16.0	14.0	84.0	81.0	
5	1051035	1050837	ROLLOX	2.1	1.36	143	105	31.2	6.35	31.8	41.7	104	33.3	28.4	21.3	19.1	16.0	90.5	82.5	
6	1051046	1050848	ROLLOX	3.6	1.72	158	119	31.8	6.35	35.3	41.7	116	39.9	34.0	24.6	22.4	19.1	103	90.0	
7	1051057	1050859	ROLLOX	3.8	2.68	168	132	28.4	6.35	38.1	51.0	125	41.4	36.6	28.7	25.4	22.4	116	105	
8	1051068	1050870	ROLLOX	5.0	3.54	182	147	26.9	7.11	44.5	57.0	148	51.0	41.9	31.2	28.4	23.9	129	114	
9	1051079	1050881	ROLLOX	6.5	4.90	199	164	26.9	7.87	47.8	63.5	165	52.5	46.0	35.1	31.8	26.9	141	125	
12 ‡	1051101	1050903	TIP-LOK	11.2	12.7	267	225	31.8	9.65	63.5	82.5	221	74.5	65.5	49.3	41.4	39.6	137	118	
13 ‡	1051112	1050914	TIP-LOK	13.6	15.9	285	242	31.8	9.65	76.0	95.5	245	83.5	70.0	49.3	44.5	38.1	187	146	
14 ‡	1051123	1050925	TIP-LOK	16.8	20.4	320	273	35.8	9.65	86.0	108	279	89.0	75.5	60.5	51.0	50.8	137	102	
16	1051134	1050936	TIP-LOK	30.0	46.7	388	332	38.1	16.0	102	127	346	118	92.0	76.0	70.0	70.0	406	178	
17	1051156	1050958	TIP-LOK	60.0	168	615	522	66.8	23.9	146	178	470	165	152	113	102	100	578	356	

4:1 Design Factor. ‡Hook will have the shank extended by use of a Coupling Nut. Customer is required to complete and approve side 2 of a Crosby Bullard® hook data form.

Crosby® / Bullard Golden Gate Hooks Service Parts

Hook Size	Gate Type	BL-GA Gate Assemblies		BL-RK Gate Repair Kit Stock No.
		Manual Close Stock No.	Self Close Stock No.	
2	PIN-LOK	1100298	1100309	1100101
3	PIN-LOK	1100320	1100331	1100102
4	PIN-LOK	1100342	1100353	1100103
5	ROLLOX	1100364	1100375	1100112
6	ROLLOX	1100386	1100397	1100113
7	ROLLOX	1100408	1100419	1100123
8	ROLLOX	1100430	1100441	1100124
9	ROLLOX	1100452	1100463	1100125
10	TIP-LOK	1100474	1100485	1100133
11	TIP-LOK	1100496	1100507	1100144
12	TIP-LOK	1100518	1100529	1100155
13	TIP-LOK	1100540	1100551	1100166
14	TIP-LOK	1100562	1100573	1100177
15	TIP-LOK	1100584	1100595	1100188
16	TIP-LOK	1100606	1100617	1100199
17	TIP-LOK	1100639	1100628	1100210

Bullard® QUIC-CHECK® Deformation Indicator Table

Hook Size	Hook ID Code	AA (mm)
1	1	38.1
2	D	38.1
3	F	38.1
4	G	50.8
5	H	50.8
6	6	63.5
7	I	63.5
8	8	76.2
9	J	101.6
11	K	101.6
12	L	101.6
13	13	127.0
14	N	127.0
16	O	165.1
17	T	254.0



## HOOKS & SWIVELS

O-318



- With ball bearing swivel; attaches to chain by an alloy pin.
- Suitable for frequent rotation under load.
- O-318 Hooks utilize Crosby SHUR-LOC® positive locking hooks. Latch is self-locking when hook is loaded.
- O-319 Hooks utilize Crosby® standard 319 Shank Hooks which incorporate QUIC-CHECK® deformation and angle indicators. (For detailed information, see the Crosby Value Added page at the beginning of this section.)
- Entire assembly is zinc plated.
- Repair kit available consisting of bearing and spring pin.

O-319



4

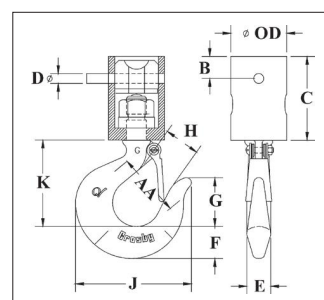
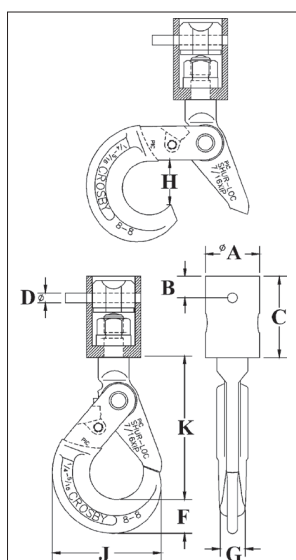

APPLICATION AND WARNING INFORMATION  
SECTION 17

### O-318 Chain Nest Hooks

Chain Size (mm)	Stock No.	Working Load Limit (t)	Weight Each (kg)	Dimensions (mm)								
				A	B	C	D	F	G	H	J	K
6 - 7	1098409	1.5	1.59	44.5	17.8	66.5	7.87	27.9	20.6	37.1	89.0	117
8 - 10	1098427	2.1	2.72	54.0	17.8	81.0	9.65	29.2	23.9	46.5	110	144
10 - 11	1098445	3.8	6.24	76.0	25.4	111	12.7	42.2	29.5	53.5	138	179
13 - 14	1098463	3.8	6.24	76.0	25.4	111	16.0	42.2	29.5	53.5	138	179

4:1 Design Factor.

### O-319 Chain Nest Hooks

Chain Size (mm)	Stock No.	Working Load Limit (t)	Weight Each (kg)	Dimensions (mm)										
				OD	AA	B	C	D	E	F	G	H	J	K
6 - 7	1098312	1.5	1.16	44.5	51.0	17.8	66.5	7.87	19.1	25.4	38.9	25.4	92.0	68.5
8 - 10	1098334	2.1	1.81	54.0	51.0	17.8	81.0	9.65	21.3	28.4	43.7	28.4	104	77.5
10 - 11	1098356	3.8	4.54	76.0	63.5	25.4	111	12.7	28.4	36.6	54.0	34.0	123	96.0
13 - 14	1098378	3.8	4.54	76.0	63.5	25.4	111	16.0	28.4	36.6	54.0	34.0	123	96.0

4:1 Design Factor. \*Deformation indicators.